

Board of Park Commissioners Approval Form

Packard Park Redevelopment Project Approval Request

Project: 2024050 QuestCDN No.: 9217415

Scope of Work:

On behalf of the Board of Park Commissioners, the City of Fort Wayne Parks and Recreation Department has requested quotes from contractors qualified to complete construction for improvements at Packard Park. This project includes all components of the redevelopment of Packard Park as documented in the bid plans and specifications.

Three quotes were received through an advertised, public bid process via QuestCDN on behalf of the Board of Park Commissioners on August 29, 2024, and Hamilton Hunter Builders, Inc. was the lowest, qualified bidder.

Board Approval:

At this time, I would like to request approval for a contract with **Hamilton Hunter Builders, Inc.** at a total cost of **\$1,457,540.00**, with the funding to come from ARPA Funds and an Invest in Neighborhoods Now (INN) grant on behalf of the Southwest Area Partnership.

The Fort Wayne Parks and Recreation and the Board of Park Commissioners, met to host their regularly scheduled monthly Board meeting on **September 12, 2024**, to approve the above-referenced project and contract, in the amount of **\$1,457,540.00**.

We, the Board of Park Commissioners, on the date stated, do ATTEST, sign the above-referenced and attached documents, and approve as presented.

Justin Shurley, President

Cory Miller, Vice-President

Richard Briley, Commissioner

Jenna Jauch, Commissioner

Steve McDaniel, Director, Board Secretary

Preliminary Bid Tabulation

Project Name: Packard Park Redevelopment

QuestCDN No.: 9217415

Project No.: 2024050

Bids Due: 8/29/2024 at 11:00am

CONTRACTOR:	Accepted Alt (Y/N)	Hamilton Hunter Builders	Schenkel Construction	Strebig Construction
Base Bid		\$1,341,407.00	\$1,400,000.00	\$1,576,100.00
Alternate No. 1 - Chain Link Fence	N	\$24,750.00	\$35,000.00	\$18,720.00
Alternate No. 2 - Decorative Lighting	Y	\$43,148.00	\$59,600.00	\$58,626.00
Alternate No. 3 - Precast Concrete Seatwall	N	\$21,186.00	\$24,000.00	\$30,449.00
Alternate No. 4 - Monument Sign Wall	N	\$14,102.00	\$13,800.00	\$11,870.00
Alternate No. 5 - Skate Ramp and Paving	N	\$43,305.00	\$42,400.00	\$54,969.00
Alternate No. 6 - Existing Tree Relocation	N	\$9,650.00	\$8,350.00	\$15,508.00
Alternate No. 7 - Futsol Court Lighting	Y	-\$27,015.00	-\$27,015.00	-\$32,215.00
Allowance		\$100,000.00	\$100,000.00	\$100,000.00
TOTAL (with allowance and all alternates)		\$1,570,533.00	\$1,656,135.00	\$1,834,027.00

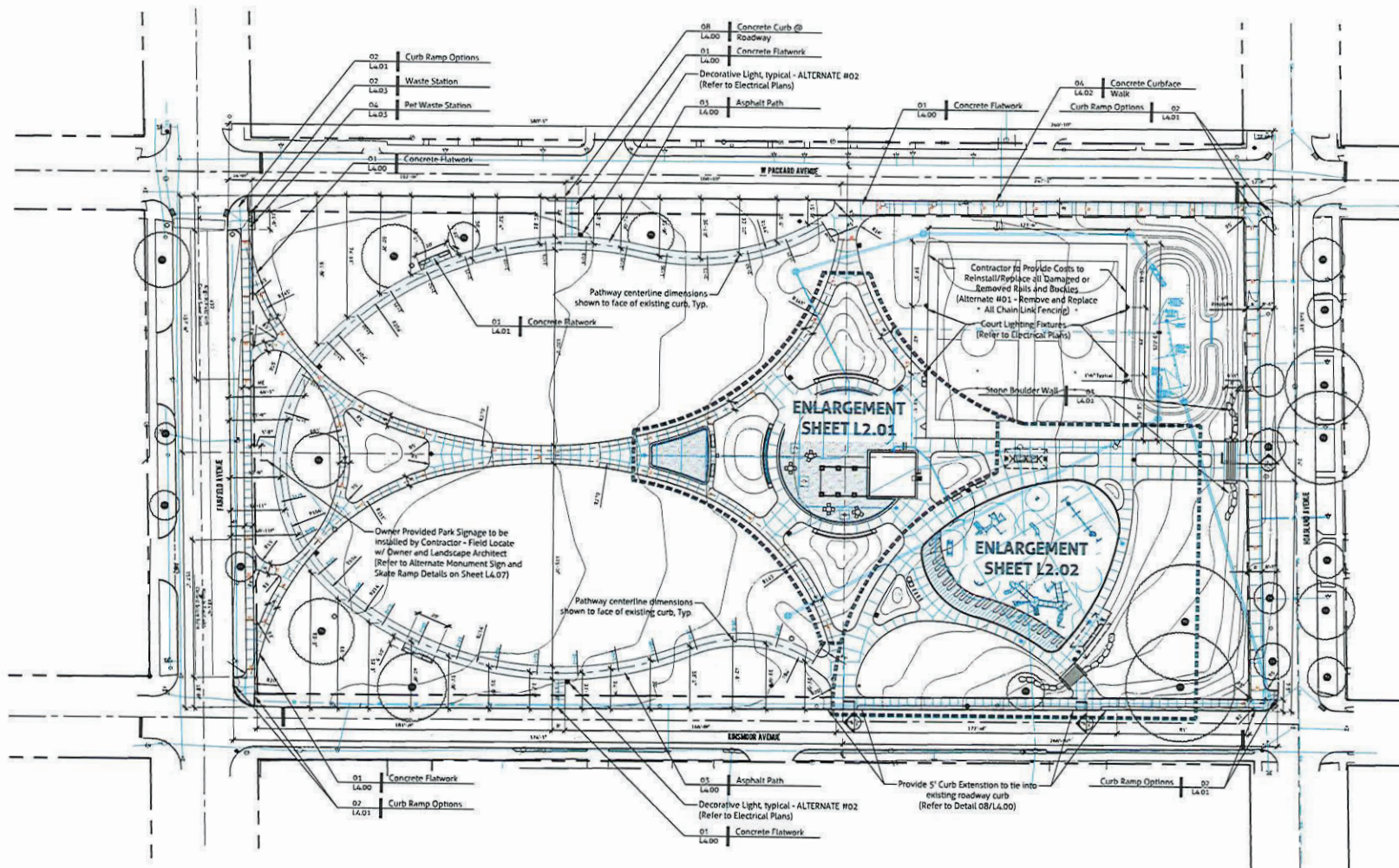

LAYOUT NOTES

- Contractor responsible for field layout of all new improvements. Digital files of geometric information will be provided upon request in AutoCAD format. No additional payment will be made for adjustments necessary to construct the work as drawn.
- Contractor responsible to coordinate work in order to obtain approval of all layout by Owners Representative prior to construction. No additional payment will be made to correct work if constructed incorrectly without pre-approval by Owners Representative.
- Contractor responsible to maintain all layout stakes during construction. No additional payment will be made to replace layout stakes.
- All walls are dimensioned to Face of Wall unless otherwise noted.
- All dimensions from roadway are from Back of Curb unless otherwise noted.
- All curves and radii to be smooth and not segmented.
- Contractor to provide layout stakes every 10 feet minimum for large arcs where radius points are not accessible.
- Adjustment to stake locations due to discrepancies between coordinates and dimensions is incidental to the contract. No additional payments will be made for this work.
- Contractor responsible to take delivery, assemble and install all materials and furnishings per manufacturer's instructions.
- Refer to specifications for additional conditions, standards and notes.
- Place control and expansion joints as shown on plans and details for all curbs, walls, steps, and concrete paving. Where joints are not shown, place control joints a maximum of 10 feet on center, expansion joints a maximum of 30 feet on center, and between all separate pours.

LEGEND - LAYOUT

- Concrete Flatwork
- Synthetic Playground Turf
- Permeable Unit Paving
- Expansion Joint
- Table & Chairs
- Bench
- Relocated Bike Racks
- Picnic Table (By Owner)