

Board of Park Commissioners Approval Form

Packard Park Playground Safety Surfacing

Project: 2024062

Project Approval Request

Scope of Work:

On behalf of the Board of Park Commissioners, the City of Fort Wayne Parks and Recreation Department requested a quote from one vendor to provide the installation of playground safety surfacing for the forthcoming new playground at Packard Park. This project is to be completed in concurrence with the current, overall park redevelopment project.

One quote for the project was received on behalf of the Board of Park Commissioners on November 21, 2024. ForeverLawn, Northeast Indiana submitted their quote, reflecting commodity pricing through the Sourcewell program, and is recommended for project award.

Board Approval:

At this time, I would like to request approval for a contract with **ForeverLawn, Northeast Indiana** at a total cost of **\$204,430.18**, with the funding to come from the Parks Cumulative Capital Fund.

The Fort Wayne Parks and Recreation and the Board of Park Commissioners, met to host their regularly scheduled monthly Board meeting on **February 13, 2025**, to approve the above-referenced project and contract, in the amount of **\$204,430.18**.

We, the Board of Park Commissioners, on the date stated, do ATTEST, sign the above-referenced and attached documents, and approve as presented.

Justin Shurley, Commissioner

Cory Miller, Commissioner

Richard Briley, Commissioner

Jenna Jauch, Commissioner

Steve McDaniel, Director, Board Secretary

		Sourcewell Pricing Worksheet For Catalog & Price Sheet Type Purchases		Project: Packard Park Date: 11/01/2024	
This Worksheet is prepared by ForeverLawn Northeast Indiana and given to End User. If a PO is issued, both documents MUST match and be mailed or emailed to marci@nein.foreverlawn.com therefore please type of write legibly.					
ForeverLawn Sourcewell Account #: 031622 - FVL Customer Sourcewell Account #:					
Estimated Delivery & Completion Date:					
A. Sourcewell Published Items					
Quantity	Item	Description	Unit Price	Total	
8865	FPUA	Playground Grass Ultra - Green- 8,865 sqft	\$6.45	\$57,179.25	
1179	SFP20	Safety Foam Pro 2" (2' x 4' panels)	\$21.96	\$25,890.84	
4	MMSEAM-WD	14" Micro Mechanical Bond Seam Tape - 162' roll	\$646.61	\$2,586.44	
1	MAPGT-12	Mapei Glue Tubes - Case of 12	\$176.90	\$176.90	
1	TearOut	Removal of ground or existing surface	N/A		
636	Bear Board/Install	Installation of EPS by Bear Board (SOLD BY LINEAR FOOT) 2"x4", varying lengths	\$5.50	\$3,498.00	
8650	Stone	Installation of stone base	\$1.80	\$15,570.00	
8650	Flins	Installation of ForeverLawn Premium Artificial Grass	\$5.50	\$47,575.00	
8650	Cutouts	Surcharge for playground cutout/poles	\$0.45	\$3,892.50	
Subtotal A:				\$156,368.93	
B. Unpublished Options, Accessory or Service Items					
Quantity	Item	Description	Unit Price	Total	
130	Infill	Crumb Rubber Infill (50# bags)	\$30.00	\$3,900.00	
8,650	SafetyFoam/Install	Installation of SafetyFoam	\$0.30	\$2,595.00	
81	Stone	81 ton of stone	\$20.00	\$1,620.00	
1	Custom	Custom Black/White Piano Keys	\$30,000.00	\$30,000.00	
8,650	Misc.	Miscellaneous Supplies: ie. (staples, anchors, screws, etc.)	\$0.15	\$1,297.50	
1	SHIP		N/A	\$8,648.75	
Subtotal B:				\$48,061.25	
C. Total Purchase Price (A+B):				\$204,430.18	



FORT WAYNE PARKS AND RECREATION

705 E. State Blvd.

Fort Wayne, IN 46805

(260) 427-6000

www.fortwayneparks.org

February 7, 2025

Memo

Fort Wayne Parks and Recreation has chosen to utilize Sourcewell for cooperative purchase of synthetic turf playground safety surfacing at Packard Park. This program has been utilized to purchase similar safety surfacing on a previous project at Kreager Park and Boone Park.

Information Regarding Sourcewell Cooperative Purchasing

Cooperative purchasing provides ready-to-use, competitively solicited contracts. Procurement is conducted by, or on behalf of, one or more Public Procurement Units as defined by the American Bar Association Model Procurement Code for State and Local Governments. Sourcewell's analysts streamline the procurement process by developing RFPs and IFBs for national, competitive solicitations that meet or exceed local requirements. Sourcewell's process is continually refined to best meet the needs of participating agencies and offers exceptional products from nationally acclaimed suppliers.

Sourcewell was created by state law as a service cooperative to provide programs and services to education and government. Sourcewell was established with the statutory purpose to assist public agencies in meeting specific needs which are more efficiently delivered cooperatively than by an entity individually.

As a service cooperative, Sourcewell is a local government unit, public corporation and public agency pursuant to the Minnesota Constitution and enabling law Minn. Stat. § 123A.21. All Sourcewell employees are government employees. Sourcewell is governed by an eight-member board made up of local elected officials including county commissioners, city council members, mayors, and school board members.

Sourcewell is authorized to establish competitively awarded cooperative purchasing contracts on behalf of itself and its participating agencies. Sourcewell follows the competitive contracting law process to solicit, evaluate, and award cooperative purchasing contracts for goods and services. Sourcewell cooperative purchasing contracts are made available through the joint exercise of powers law Minn. Stat. § 471.59 to participating agencies.

Sourcewell clients are able to utilize cooperative purchasing contracts through similar joint powers, intergovernmental cooperation, or cooperative purchasing laws in their respective jurisdiction. Participating agencies include all eligible government and education agencies.

Memo Prepared by:

Dave Weadock





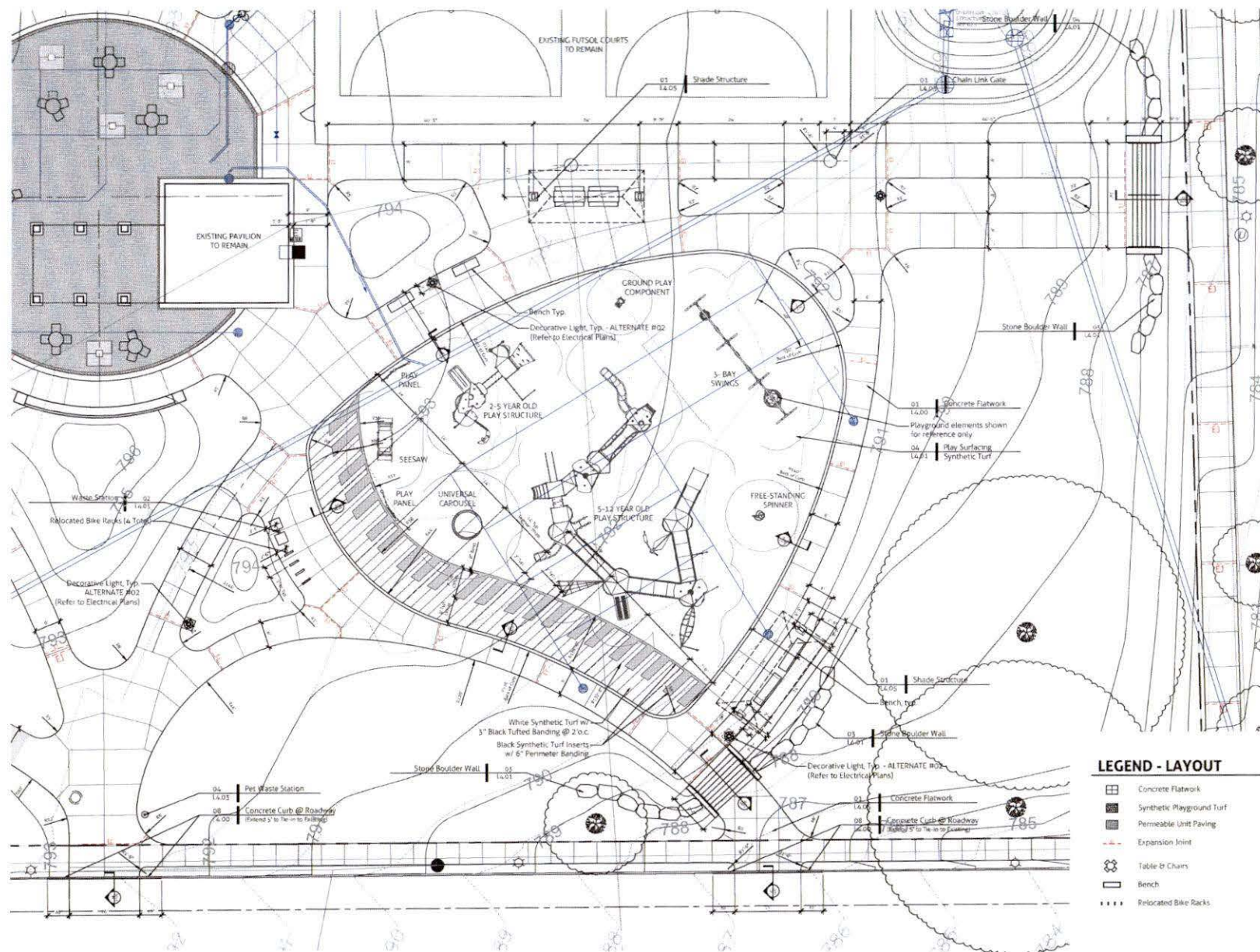

Manager of Project Administration



SHEET NUMBER
L2.02



LEGEND - LAYOUT

-  Concrete Flatwork
-  Synthetic Playground Turf
-  Permeable Unit Paving
-  Expansion Joint
-  Table & Chairs
-  Bench
-  Relocated Bike Racks